

MICROCHIP IMPLANTATION INSTRUCTIONS

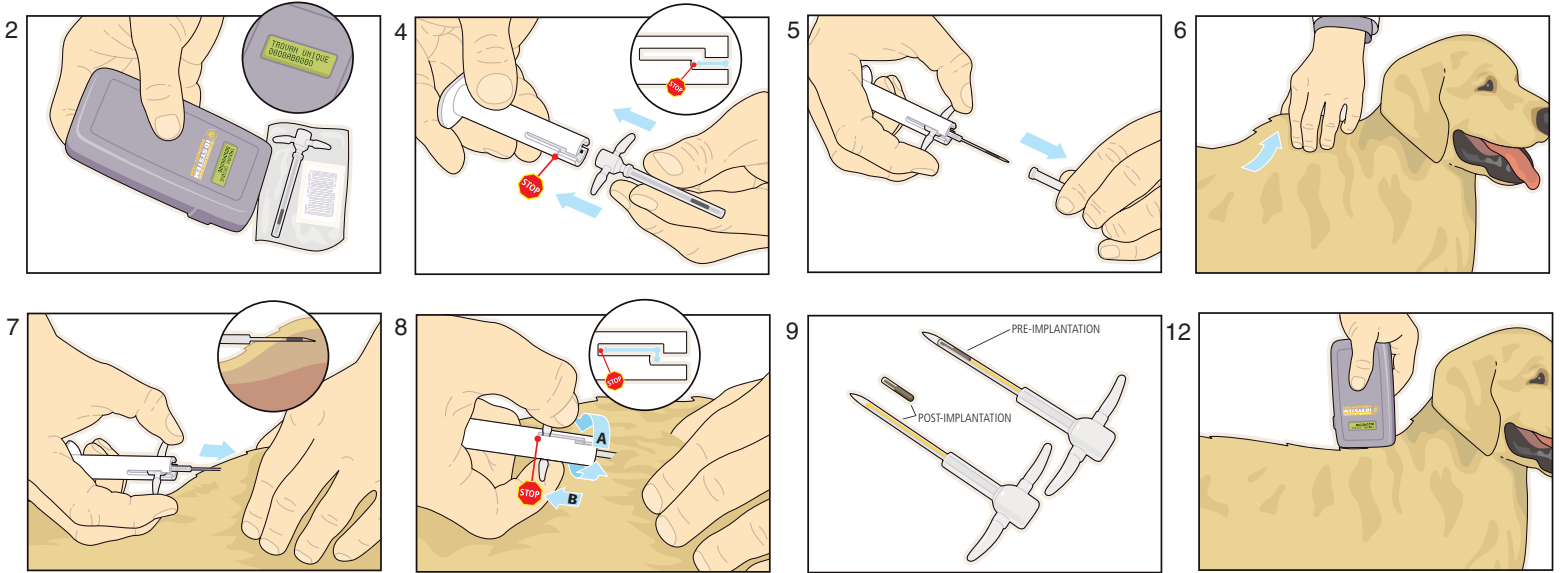

Summary

Our patented implantation system ensures precise placement while reducing the risk of damage to the microchip. Instead of being pushed out of the needle into the tissue, the microchip remains safely inside a sterile lancet as it enters the animal's subcutaneous tissue. Once the microchip is in place, simply turn the lancet counterclockwise and retract it. Then remove the lancet from the animal.

Supplies Needed:

- Lancet containing microchip
- Retractor
- Multi-system scanner
- AKC CAR enrollment form
- Sharps container

1. Scan the animal to find out if it already has a microchip. If it does, call AKC CAR immediately at **1-800-252-7894**.
2. Scan the sterile lancet in the package to confirm the ID number of the chip is the same as the one on the barcode label in the package.
3. Remove the lancet and retractor from the packaging.
4. Hold the lancet assembly by the cap and insert into the retractor until firmly seated on pin and settled in position 1 (first stop). The slit in the lancet should be facing you beveled side up.
5. Support the base of the retractor in the palm of your hand. Slide the cap off the lancet, while holding the lancet wings with your thumb and index finger (or in the position most comfortable to you).
6. Locate the injection site (between the shoulder blades) and, using your thumb and index finger, pull some loose skin to tent the skin.
7. With the lancet seated in position 1, insert it at the base of the tent at a shallow angle. Insert the lancet subcutaneously up to the hub to ensure contact with the tissue.

- 8a. Twist the wings of the lancet counterclockwise until they slide into the lower channel.
- 8b. Pull the wings toward you slowly until the lancet wings are firmly seated at the bottom of the retractor channel while leaving the retractor in place. Remove the lancet from the animal. Release the tented skin and apply pressure to the injection site.
9. Check the lancet and confirm that the ImplantGauge™ is in the full, extended position. The yellow push rod will be visible along the entire length of the lancet.
10. Replace the protective cap on the used lancet and remove the lancet assembly from the retractor.
11. Discard the used lancet in the sharps container. **Save the retractor for multiple use.**
12. Scan the injection site to ensure the microchip is working correctly and double-check the number on packaging.
13. For immediate enrollment, log onto www.akccar.org and click on **"Enroll Today."** Or the pet's owner can mail the completed paper form to AKC CAR.

- *Should be administered by or under the direct supervision of a veterinarian and in accordance with any state and local statutes and regulations applicable to microchips and their implantation.*
- *Do not autoclave lancet.*
- *Store the AKC Companion Animal Recovery ID System™ at room temperature.*



Manufactured for: AKC Companion Animal Recovery,
8051 Arco Corporate Drive, Raleigh, NC 27617-3900.